

# STATIPOWER<sup>®</sup> SP11

## Radio Frequency Induction Heating Power Supplies

### Features/Benefits:

- Application flexibility with a tuning range of 50-200 kHz.
- Continuous or intermittent duty
- 100% solid state design.
- Ideal replacement for less efficient oscillator tube power supplies.
- High, 0.95 input power factor under all operating conditions.
- $\pm 1\%$  output regulation accuracy with  $\pm 10\%$  line variance under all operating conditions.
- Single control board for reliable operation and simplified maintenance.
- Analog display of voltage, frequency, current and output power.
- Built-in digital heat timer.
- Optional RS-232/485 interface for automatic operation under computer control.
- Built-in load matching capacitors and variable ratio isolation transformer.



SP11 100 kW / 150 kHz

### RF Power Supplies For General Purpose Induction Heating

STATIPOWER<sup>®</sup> SP11 is a self-contained, stand-alone solid state transistorized power supply for heating a wide variety of parts. Application capabilities include hardening, tempering, brazing, soldering, melting, bonding and shrink fitting. A broad range of single-turn and other low impedance heating coils can be properly matched with built-in load tuning capacitors and multi-tap output isolation transformer.

### Compact Design For Stand Alone Operation

STATIPOWER<sup>®</sup> SP11 power supplies are up to 80% smaller and up to 2,000lbs. lighter than conventional RF power supplies. This efficient use of space is achieved without sacrificing performance. Output power regulation is  $\pm 1\%$  with up to  $\pm 10\%$  line variance; the input power factor is 0.95, regardless of loading; and energy conversion efficiency exceeds 85% (a tube style RF oscillator is typically 50% efficient to the load).

### Manual or Computer Controlled Operation

All controls necessary for stand-alone operation are built into STATIPOWER<sup>®</sup> SP11 power supplies. This includes a digital heat cycle timer, analog meters for voltage, frequency, current and power, and LED operating and diagnostic indicators. For automatic control and/or record keeping, an optional RS-232/485 interface is available. The only installation requirements are power and water.

# STATIPOWER<sup>®</sup> SP11

## Radio Frequency Induction Heating Power Supplies

### SPECIFICATIONS:

| Output Power at 50-200 kHz | Input kVA (max.) | Water Req. for 25 psi Pressure Drop | Dimensions WxDxH in. (mm) | Shipping Weight Pounds (kg) |
|----------------------------|------------------|-------------------------------------|---------------------------|-----------------------------|
| Floor model 50 kW          | 62 kVA           | 10 gpm (38 lpm)                     | 40x40x72 (1016x1016x1800) | 770 (349)                   |
| Floor model 100 kW         | 124 kVA          | 18 gpm (68 lpm)                     | 52x40x72 (1300x100x1800)  | 980 (445)                   |
| Floor model 150 kW         | 190 kVA          | 30 gpm (110 lpm)                    | 52x40x72 (1300x100x1800)  | 1100 (500)                  |

### COMMON FEATURES:

|  |  |
|--|--|
| <b>Energy Conversion Efficiency</b>              | 85% minimum  |
| <b>Input Power Factor</b>                        | 0.95   |
| <b>Output Regulation</b>                         | Voltage, power or current  |
| <b>Regulation Accuracy</b>                       | ±1% with ±10% line variance  |
| <b>Water Requirements</b>                        | 95° F (max.) (35° C)   |
| <b>Power Requirements</b>                        | 480 V, 3 Phase, 50/60 Hz   |
| <b>Operator Controls</b>                         | Panel-mounted analog meters for voltage, frequency, current and output power. LED operation and diagnostic indicators. Built-in digital heat cycle timer. Power, voltage or current control. Manual/timed selector switch. Local/remote control selector switch. Ten turn output control potentiometer. On-Off push buttons. Remote 0-10 volt or 4-20 m. |
| <b>Safety Features</b>                           | Fast-acting, semiconductor-type fuses. No high voltages.   |
| <b>Optional features</b>                         | RS-232/485 interface.  |
| *Specifications subject to change without notice |  |

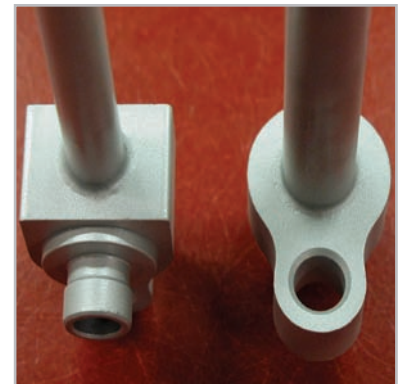

Brazed parts



Tempered parts



ISO 9001:2000 Certified

©2007 Inductoheat, Inc. All Rights Reserved. LITHO IN U.S.A 1M 01/07 BULLETIN P-26 Rev 4